

SHIMANO

1994 REPAIR MANUAL

Shimano American Corporation, One Shimano [Irvine, CA 927

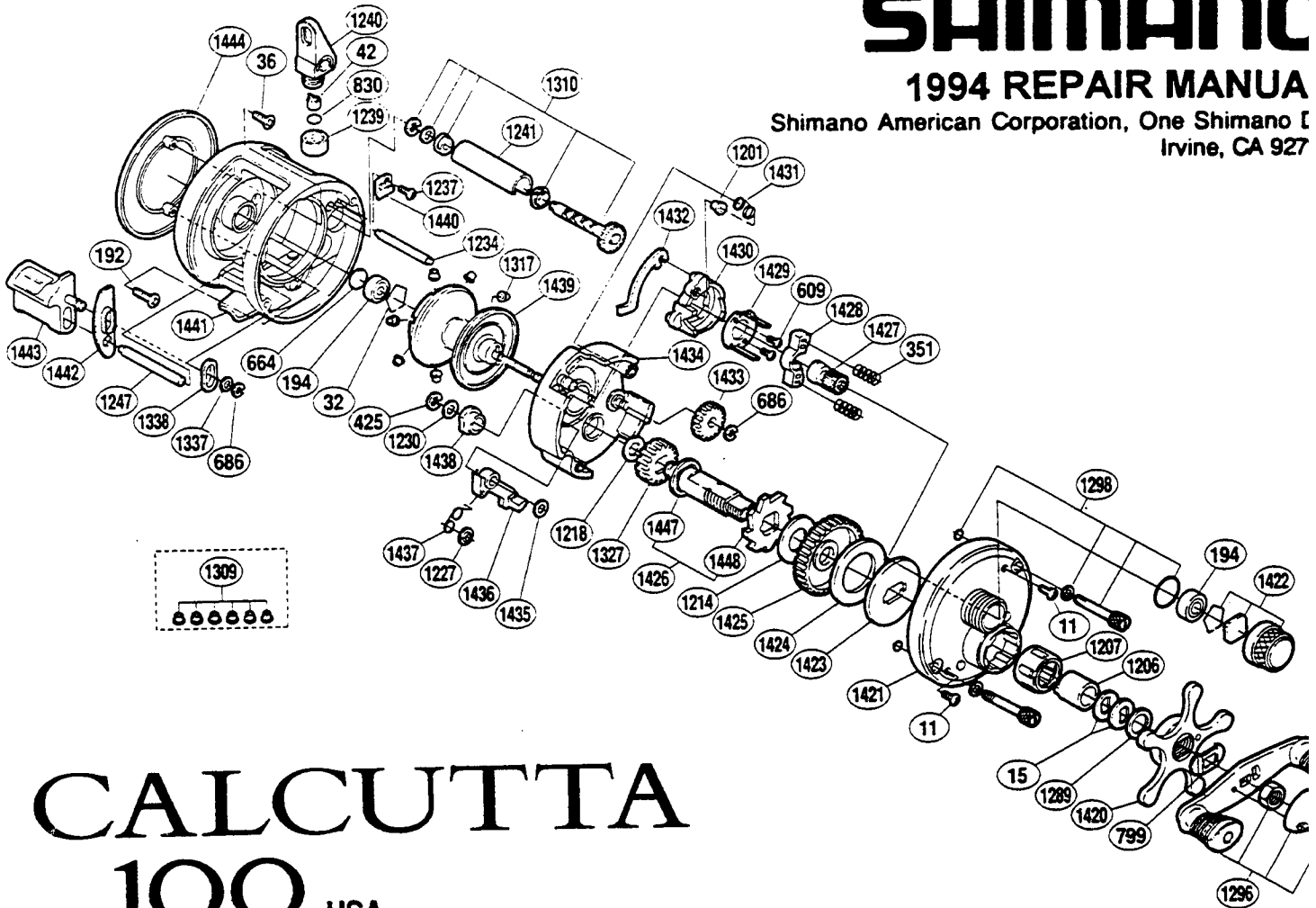

CALCUTTA 100 USA

CT100

PART #	DESCRIPTION	PART #	DESCRIPTION	PART #	DESCRIPTION
BNT0011	Right Side Plate Screw	BNT1234	Level Wind Guide	BNT1426	Drive Shaft
BNT0015	Drag Spring Washer	BNT1237	Worm Bearing (A) Ret. Screw	BNT1427	Pinion Gear
BNT0032	Bearing Retainer	BNT1239	Pawl Cap	BNT1428	Yoke
BNT0036	Left Side Plate Screw	BNT1240	Line Guide	BNT1429	Clutch Cam Retainer
BNT0042	Line Guide Pawl	BNT1241	Level Wind Guard	BNT1430	Clutch Cam
BNT0192	Left Side Plate Screw	BNT1247	Clutch Bar Support	BNT1431	Retractor Spring
BNT0194	Ball Bearing	BNT1289	Star Drag Spacer	BNT1432	Clutch Plate
BNT0351	Yokde Spring	BNT1296	Handle Assembly	BNT1433	Idle Gear (B)
BNT0425	"E" Lock	BNT1298	Rt. Side Plate Bolts Assembly	BNT1434	Set Plate
BNT0609	Clutch Cam Spring	BNT1309	Brake Collar (green)	BNT1435	Clutch Pawl Spacer
BNT0664	Spacer (B)	BNT1310	Worm Shaft Assembly	BNT1436	Clutch Pawl
BNT0686	Idle Gear (B) Retainer	BNT1317	Brake Collar (red)	BNT1437	Clutch Pawl Spring
BNT0799	Friction Washer	BNT1327	Idle Gear	BNT1438	Drive Shaft Bushing
BNT0830	Spacer (optional)	BNT1337	Clutch Bar Support Spacer	BNT1439	Spool Assembly
BNT1201	Retractor Spring Collar	BNT1338	Clutch Bar Guide (A)	BNT1440	Worm Bearing (A) Retainer
BNT1206	Roller Clutch Inner Tube	BNT1420	Star Drag	BNT1441	One-Piece Frame
BNT1207	Roller Clutch Bearing	BNT1421	Right Side Plate	BNT1442	Clutch Bar Guide (B)
BNT1214	Drag Washer (A)	BNT1422	Cast Control Cap Assembly	BNT1443	Quick-Fire II Clutch Bar
BNT1218	Idle Gear (A) Spacer	BNT1423	Key Washer	BNT1444	Left Side Plate
BNT1227	Clutch Pawl Spring Retainer	BNT1424	Drag Washer (C)	BNT1447	Drive Shaft
BNT1230	Drive Shaft Spacer	BNT1425	Drive Gear	BNT1448	Anti-Reverse Ratchet